

LMI MANUFACTURING GROUP, LLC  
 1802 North Carson Street, Suite 212-2656  
 Carson City, NV 89701  
 (P)866-770-9416 (F)877-469-3625

CONTROLS

## TRACE E55A-E21BS LINE SENSING THERMOST

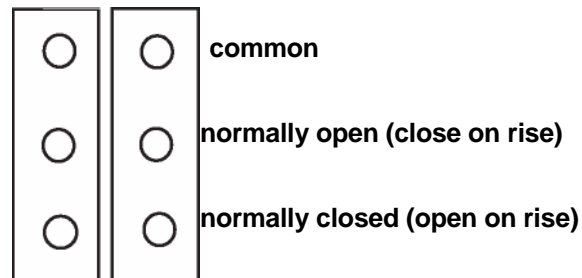
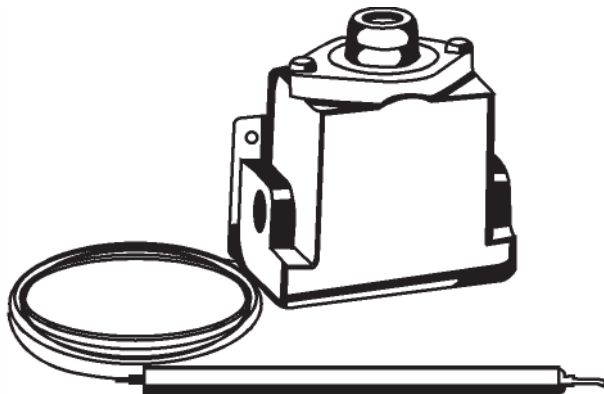

### Description

LMI's Power-trace E55A-E21BS can be applied as a line sensing or ambient sensing thermostat. It is designed to protect against dust, water and rain. The enclosure is NEMA 4, and covers are gasketed. The switching is dual SPDT. The switch may be separated up to 100% of range. Switches may be wired normally open, or normally closed. The bulb and capillary are stainless steel and the fill is non-toxic oil which is not affected by barometric pressure. The thermostat is screw mounted. There is one 1/2" threaded conduit opening at the bottom of the unit. The adjustment knob is side mounted and covered.

### Applications

E55A thermostats typically control:

- Pipe Trace Systems
- Tank Trace Systems
- Permafrost Prevention Systems

### Approvals

UL Listed CSA  
 Certified

### Terminal block

The terminals use #6-32 screws.  
 - For heating applications, wire into **common** and **normally closed**.

Line Diagram for E55A-E21B  
 Dual SPDT Thermostat

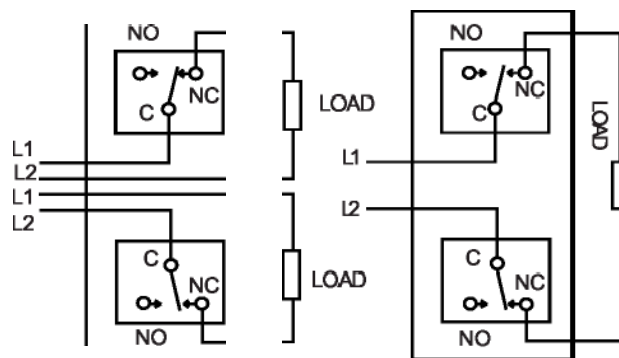

For Heating Applications (open on rise)  
 Wire Common to NC.



Warning: The E55A-E21BS thermostat must be installed by a qualified electrician. All assembly, installation, and test instructions must be followed. Improper installation can result in property damage, serious injury or death due to electric shock. Please call LMI at 1-866-770-9416 with any installation or operating questions.

## A319ABC Specifications

**Enclosure:** NEMA 4

**Switch:** Two SPDT

**Adjustable Range:** ° to 150°F (-15 - +65°C) **Max.**

**Allowable Temp.:** 1600°F

**Electrical Rating:** 15 Amps, 480 VAC

**Sensor:** Stainless Steel, 6' capillary

## Installation

Follow all instructions included with thermostat. Follow all prevailing building and/or electrical codes.

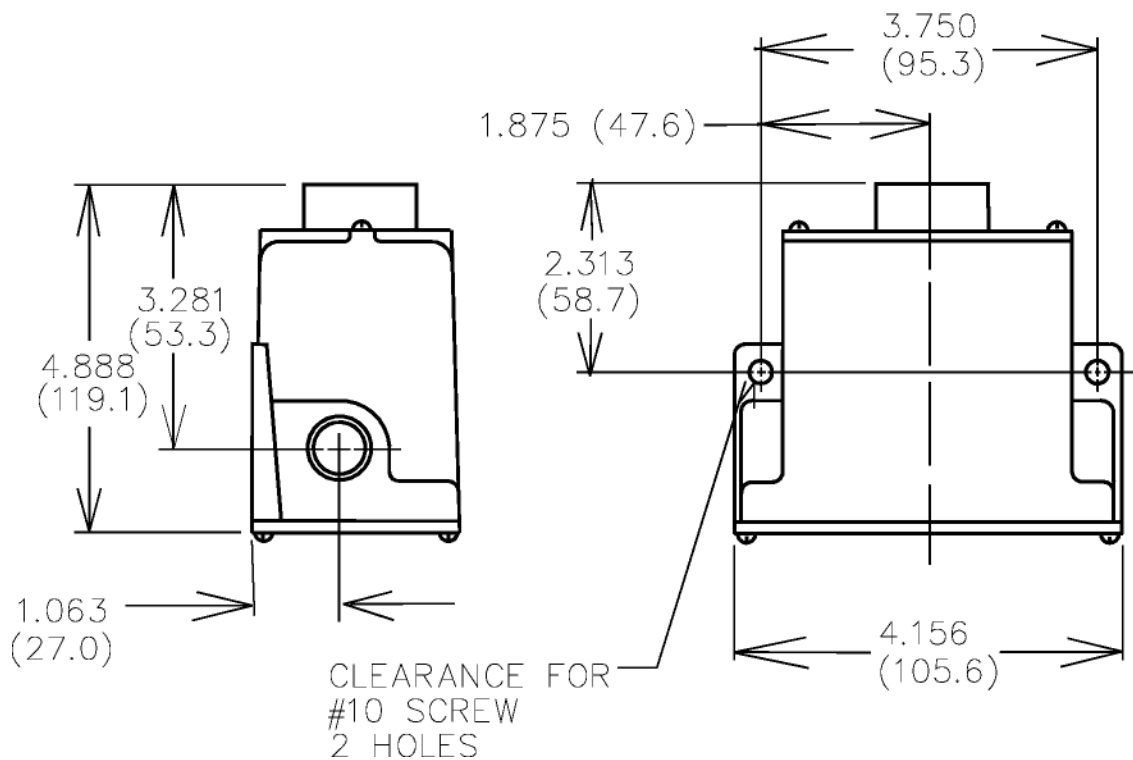

**All dimensions are in inches (millimeters).**